

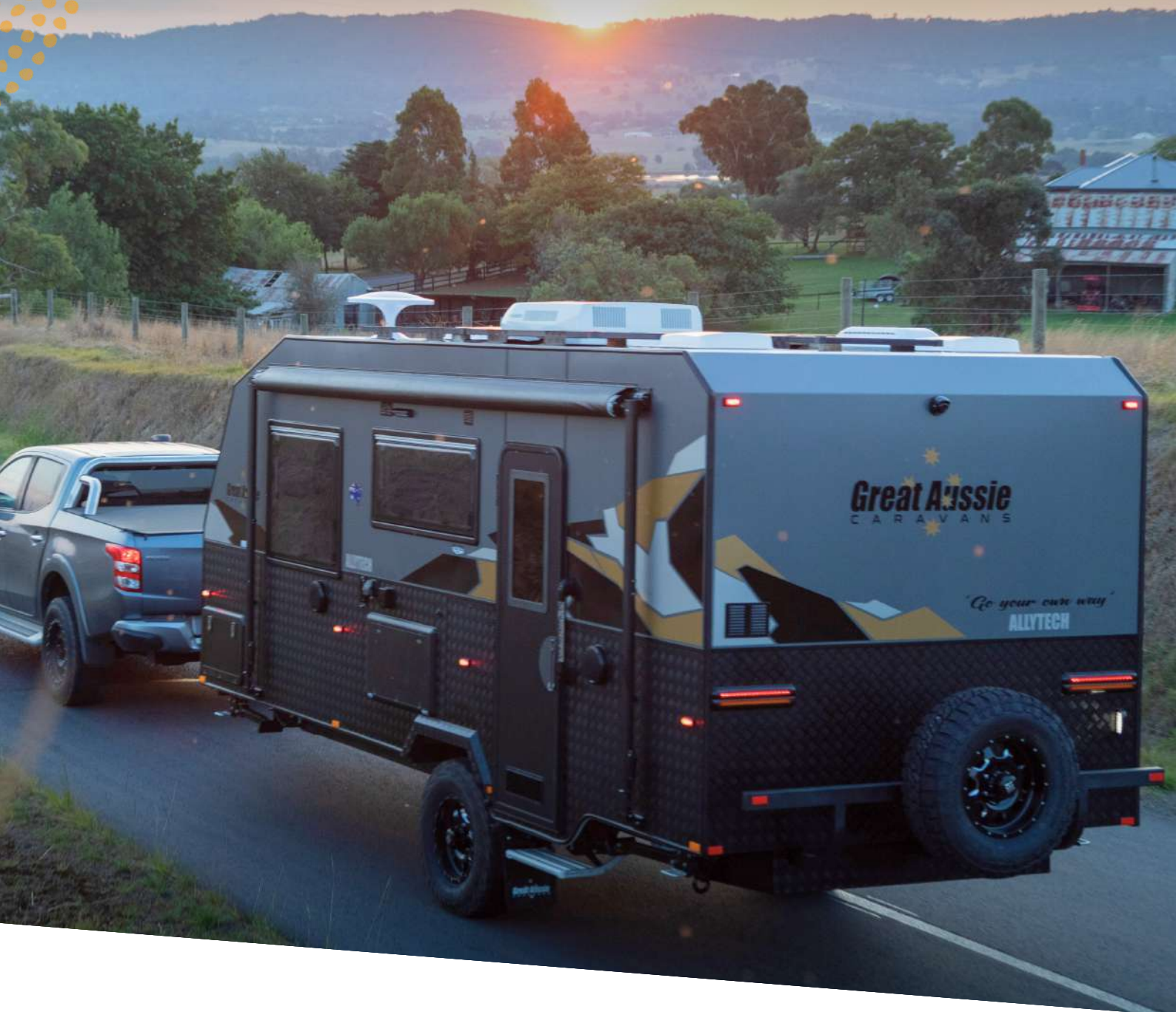

Great Aussie
CARAVANS



2OURER

ON ROAD TOURING

2024

WWW.GREATAUSSIECARAVANS.COM.AU

PH: (03) 9308 8511



Great Aussie
CARAVANS

"Go your own way"
ALLYTECH



Perfect on road model for touring in style! Designed to provide an unparalleled experience for keen travelers, this light weight model embodies a harmonious blend of affordability, comfort and convenience. Embrace the freedom of the open road and embark on new horizons with your loved ones in your Great Aussie 2000r.

CHASSIS & PROTECTION

- Reliable leaf spring suspension (2.5T single axle & 3.2T tandem axle)
- 235/75/R15 all terrain tyres on load-rated alloys
- 10" drum brakes (tandem axle) or 12" drum brakes (single axle)
- Standard 50mm ball coupling
- Supagal chassis made with Australian RHS steel
- 6" drawbar with 4" chassis and 2" chassis raiser (tandem axle)
- Rear 2 arm bumper bar
- Mud flaps to avoid stones

APPLIANCES

- Dometic reverse cycle air-conditioner
- 188L 3-way fridge / freezer
- Premium front loader 3.5 kg washing machine (Excludes 17' model)
- 24" Smart TV (12V)
- Wingard TV antenna
- Microwave
- Stove top with 3 gas, 1 electric element with separate grill
- Bluetooth sound system with internal & external speakers
- Smoke alarm



ELECTRICAL

- 200W of solar power (1 x 200W panel)
- Projecta 100Ah high discharge lithium battery
- Projecta PM300 battery management system
- External rear camera
- Internal LED bulkhead lighting
- LED reading lights at bed head & dinette with USB output
- Remote LED lights throughout the van
- Premium quality roof hatch with LED lights
- Rear LED tail lights
- Radio antenna

EXTERNAL FEATURES

- Aluminum composite outside walls
- High checker plate for protection
- Premium, one-piece, fiberglass roof
- One-piece floor as per your build selection
- Roll-out awning
- Full length tunnel boot with lights inside
- External TV bracket, antenna, 12V and 240V power outlets
- Premium 3-point locking system, alloy SecuraMesh door
- Built-in external generator compartment (as per floor plan)
- Wheel arch with aluminium checker plate armour moulds
- External gas bayonet to the awning side of the caravan for BBQ
- Anderson plug to charge battery from car
- External grab handle with LED light
- Premium quality picnic table with LED lights

INTERNAL FEATURES

- Deluxe 6'2" pillow-top mattress
- Large size double glazed windows
- Nooks beside master bed with 240V & USB outlets for electronic device charging
- Modern CNC interior
- Comfortable dual density lounges with premium automotive grade, upholstery
- Soft close drawers on ball-bearing runners
- Premium brushed door & drawer catches (as per your build selection)
- Block out blinds and pulldown mesh screens to all windows
- Stylish acrylic finished cabinetry
- Recessed stove cover
- Pull-out pantries (as per floor plan)
- Large stylish grab handle on entry wall
- Premium quality ensuite mirror with additional magnifying glass

PLUMBING

- 190L of drinking water capacity (2 x 95L tanks)
- 12V water pump
- 2 x 9Kg gas bottles
- Gas / electric hot water system
- Digital water tank level display
- Ceramic inlay cassette toilet
- Flick mixer taps throughout
- Hidden plumbing and waste lines inside cabinetry (wherever possible)
- Lockable water filler to each water tank
- Tap on A-Frame with guard

COUPLES FLOOR PLANS

15'6

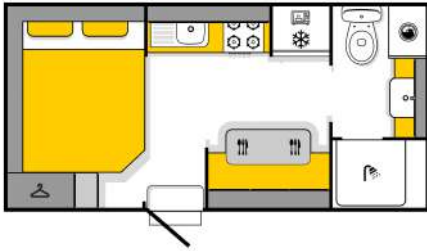

17'6

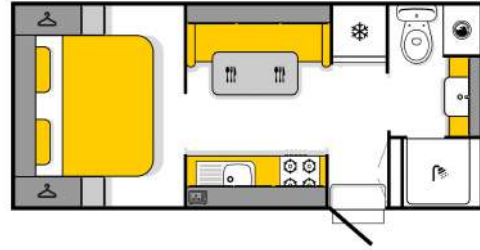

18'6

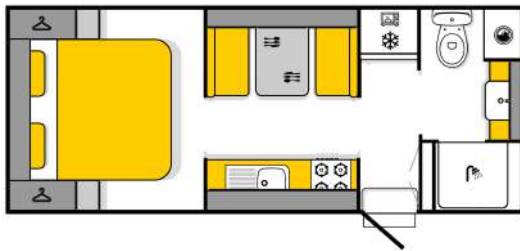

18'6

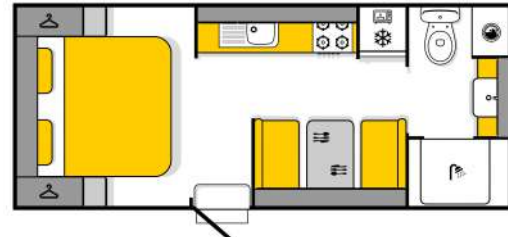

19'6

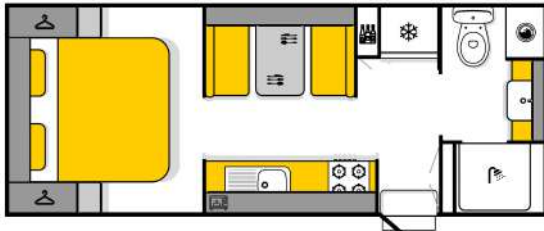

20'6 Club

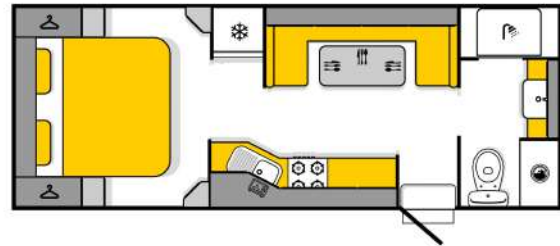

20'6

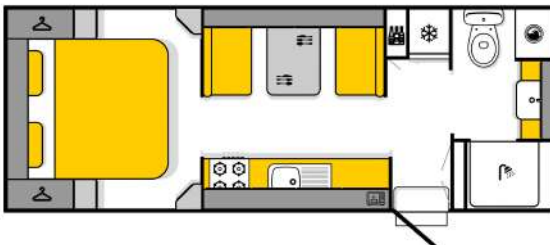

21'6

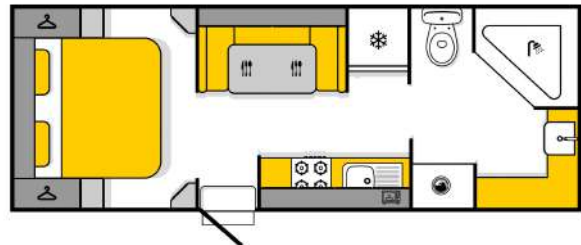

22'6

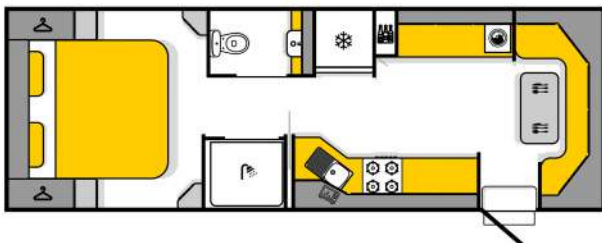

**Floor plans are for illustrative purposes only & are not to scale.
Components shown may be different to actual caravans.*

FAMILY FLOOR PLANS (TRIBAL)

18' Side Bunk

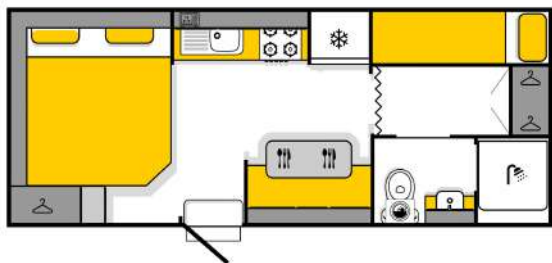

18' Rear Bunk

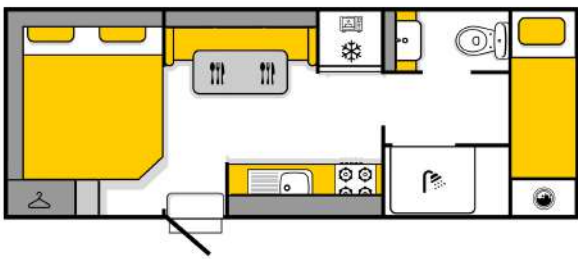

20'6

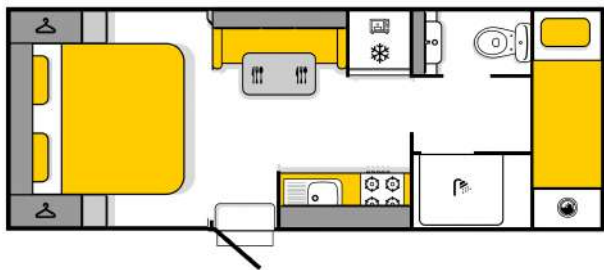

20'6

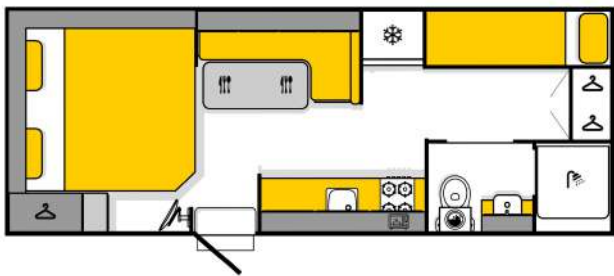

21'6

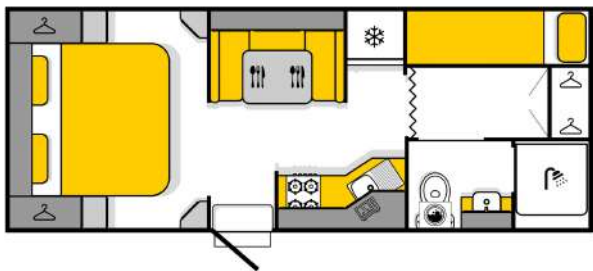

22'6

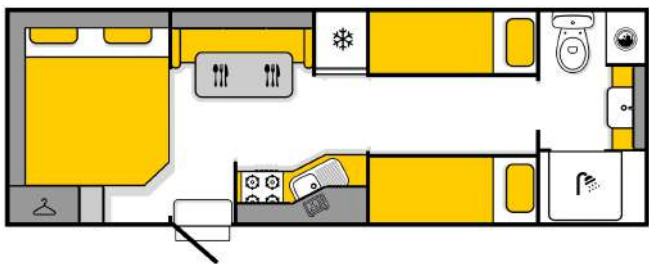

**Floor plans are for illustrative purposes only & are not to scale.
Components shown may be different to actual caravans.*





CONSTRUCTION TYPES AVAILABLE

Great Aussie Caravans is the only manufacturer to offer three different construction techniques for new caravans. Once you've selected the desired floor plan and model, you can choose from Timbertech, Allytech, or Fibretech as your preferred construction methodology.



- Meranti timber frame
- Tried & proven construction
- Flexible to allow movement whilst maintaining strength
- One piece, timber flooring
- Light weight interlocking CNC cabinetry provides strength & accuracy

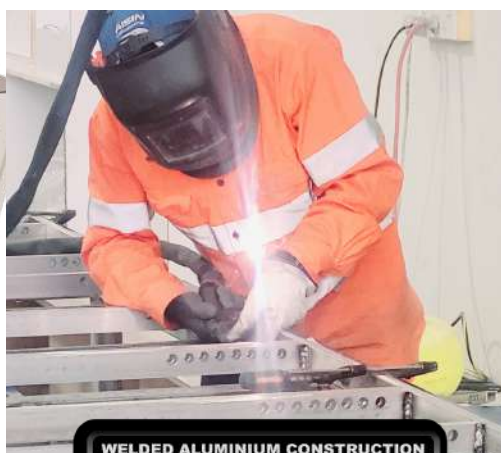

- 100% timber free walls, roof, frame & floor
- Welded aluminium frame, which is strong & light
- Walls lined with fibreglass to protect against water damage
- Composite honeycomb floor which is lighter & well insulated
- XPS insulation upgrade in walls
- Exclusive interlocking cabinetry



- ECO-Friendly recyclable material
- Odourless
- Approx. 25% lighter than traditional framing
- B1 Low flammability rating
- Moisture resistance
- Chemical and corrosion resistance
- GAC Poly board
- Exclusive interlocking cabinetry



Great Aussie

CARAVANS

Great Aussie was founded by a group of passionate adventurers who believed in the magic of creating homes-on-wheels for fellow wanderers seeking to embrace the nomadic lifestyle. Their journey began with the humble yet sturdy caravans, designed to be the perfect companions for the road less traveled. From the very first caravan that rolled out of their workshop, it was evident that they were onto something special.

With decades of experience in manufacturing, testing and most importantly caravanning, we truly believe that we build the best RVs in Australia. With thousands of happy customers and multiple awards, we believe that when you purchase a Great Aussie, you don't just become a customer, you become part of the family.

WWW.GREATAUSSIECARAVANS.COM.AU

PH: (03) 9308 8511

Disclaimer: Great Aussie Caravans reserves the right to discontinue or change the models, features, specifications, materials or designs of the RV's and any terms or offers referred to herein, at their discretion and without prior notice. Photos in this brochure may depict optional extras.